

PE Triaxial High-Impact Accelerometer Sensor

Model No: C00Y40

Product Features:

- High-Impact Triaxial Charge Output Sensor for Testing
- Special shear structure design with through-hole configuration
- The entire series uses memory alloy fasteners with shear structure for stable and reliable performance
- Titanium alloy material for lightweight design
- M5 thread output

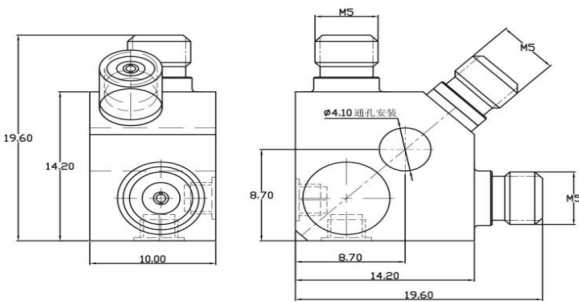

Technical specifications

Features	Units	C00Y40
Sensitivity	pC/g	0.3
Measuring Range	g	±20000
Frequency Response ±5%	Hz	-
Frequency Response ±10%	Hz	5-11k
Amplitude Linearity	%	≤3 (FS)
Transverse Sensitivity	%	≤5
Mounting Resonant Frequency	kHz	≥85

Environmental

Base strain	g/ε	0.0008
Shock Limit ¹	g pk	25000
Maximum Vibration ²	g rms	-
Sensitivity Temperature Coefficient	%/°C	0.06
Operating Temperature	°C	-50~230
Sealing Type	IP68	Laser welding

Electrical Parameters

Element Capacitance	pF	180
Element Insulation Resistance	Ω	≥1×10 ¹¹

Structure

Sensitive Element	PZ24 Piezoelectric Ceramic
Sensitive Element	Titanium Alloy
Sealing Type	Laser welding IP68
Output Connector	M5×3
Installation Type	4.1 Through Hole / M5"

Insulation Resistance to Ground	Ω	-
Mass	g	8
Recommended Installation Torque	N·m	1.6

Notes: 1,2: Refer to the sensor's mechanical structure not being damaged while in a non-powered state.

Product Factory Configuration:

- User Manual
- Factory Calibration Report
- Standard 1-meter Cable
- Installation Screws
- Installation Insulation Components